

PROPERTY MAY BE SUBJECT TO RECORDED OR UNRECORDED EASEMENTS OR RESTRICTIONS NOT OBSERVED AND TO INFORMATION REVEALED IN A COMPLETE TITLE SEARCH. THE SURVEYOR DID NOT PERFORM A TITLE SEARCH. UNDERGROUND UTILITIES MAY BE PRESENT BUT THEIR LOCATION WAS NOT DETERMINED.

LINE TABLE

| Id  | Bearing       | Distance |
|-----|---------------|----------|
| L1  | S 65°52'36" E | 9.54'    |
| L2  | S 79°20'56" E | 66.17'   |
| L3  | S 44°14'15" E | 16.20'   |
| L4  | S 19°58'43" W | 65.18'   |
| L5  | S 26°11'19" W | 28.31'   |
| L6  | S 39°24'11" E | 37.97'   |
| L7  | S 43°00'02" E | 154.46'  |
| L8  | S 63°06'46" E | 135.04'  |
| L9  | S 58°46'50" E | 79.44'   |
| L10 | S 76°13'15" E | 127.79'  |
| L11 | S 69°02'58" E | 81.92'   |
| L12 | N 63°42'53" W | 203.86'  |
| L13 | S 34°33'05" W | 7.17'    |
| L14 | S 49°35'23" W | 9.54'    |
| L15 | S 40°19'10" E | 14.90'   |
| L16 | N 63°42'53" W | 13.26'   |

L1-L12 ARE POINTS IN THE CENTERLINE OF SMITH BRANCH.

CURVE TABLE

| Id | Radius   | Arc Length | Chord   | Chord Bearing |
|----|----------|------------|---------|---------------|
| C1 | 1095.26' | 666.96'    | 656.70' | N 80°39'26" E |

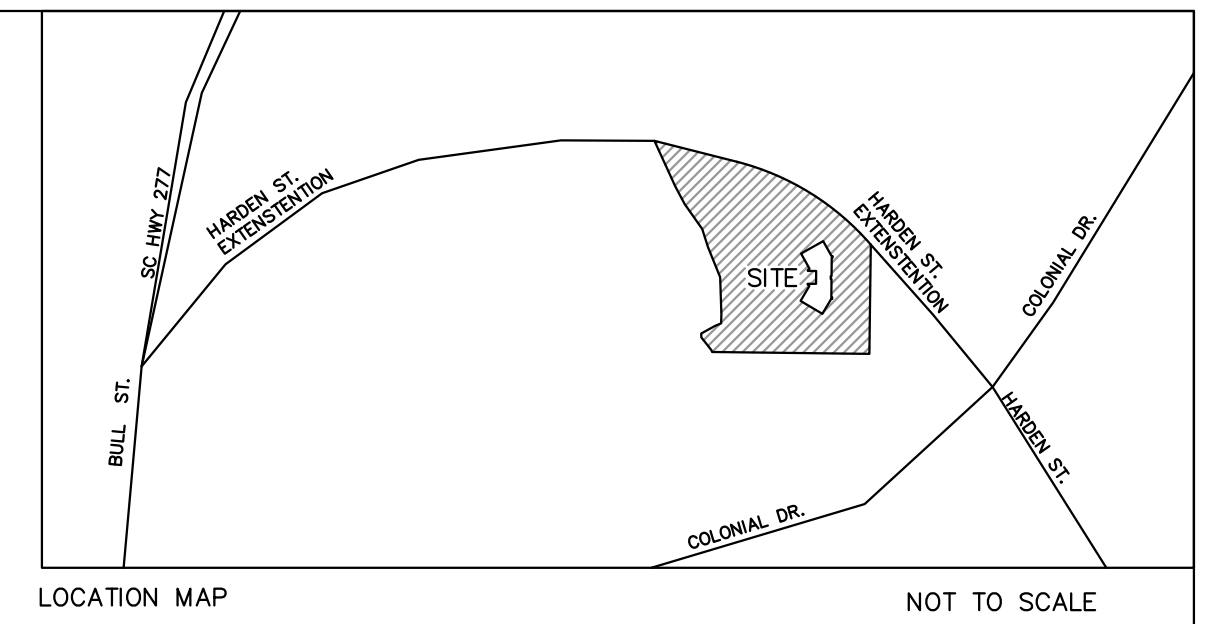

- LEGEND
- DI DROP INLET
  - WV WATER VALVE
  - WM WATER METER
  - WATER VAULT
  - GAS MARKER
  - GAS METER
  - GAS VALVE
  - CO SANITARY SEWER CLEANOUT
  - SSMH SANITARY SEWER MANHOLE
  - SDMH STORM DRAIN MANHOLE
  - PP POWER POLE
  - GW GUY WIRE
  - ELEC. BOX
  - HC HANDICAP SPACE
  - LIGHT POLE
  - FIBER OPTIC MARKER
  - COMMUNICATIONS VAULT
  - COMM BOX/PEDESTAL
  - HVAC UNIT
  - FH FIRE HYDRANT
  - ELEC. TRANSFORMER
  - MW MONITORING WELL
  - COVERED AREA

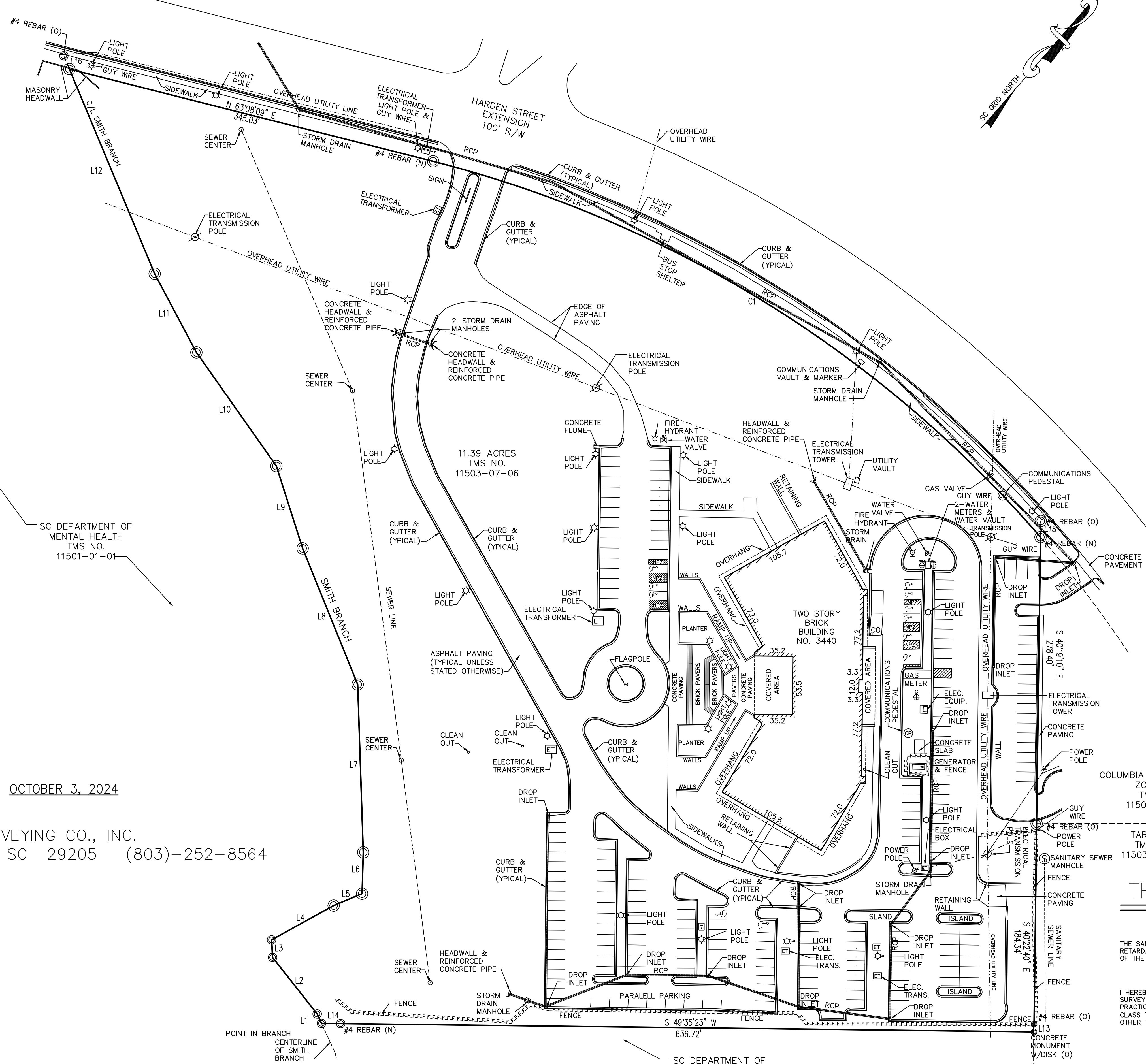

SC DEPARTMENT OF MENTAL HEALTH  
TMS NO. 11501-01-01

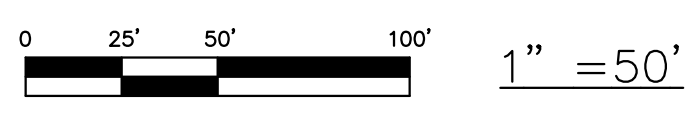

OCTOBER 3, 2024

BAXTER LAND SURVEYING CO., INC.  
2204 Devine Street Columbia, SC 29205 (803)-252-8564

COLUMBIA EMPOWERMENT  
ZONE INC.  
TMS NO. 11503-07-03

TARVI LLC  
TMS NO. 11503-07-05

PLAT PREPARED FOR  
**THE STATE OF SOUTH CAROLINA**  
RICHLAND COUNTY, COLUMBIA, SC

THE SAME BEING SHOWN ON PLAT PREPARED FOR THE SOUTH CAROLINA DEPARTMENT OF MENTAL RETARDATION, BY LEON CAMPBELL & ASSOC., INC., DATED JANUARY 10, 1987 AND RECORDED IN THE OFFICE OF THE REGISTER OF DEEDS FOR RICHLAND COUNTY IN DEED BOOK D0896, PAGE 625.

I HEREBY STATE THAT TO THE BEST OF MY PROFESSIONAL KNOWLEDGE, INFORMATION, AND BELIEF, THE SURVEY SHOWN HEREIN WAS MADE IN ACCORDANCE WITH THE REQUIREMENTS OF THE STANDARDS OF PRACTICE MANUAL FOR SURVEYING IN SOUTH CAROLINA, AND MEETS OR EXCEEDS THE REQUIREMENTS FOR A CLASS "B" SURVEY AS SPECIFIED THEREIN, ALSO THERE ARE NO VISIBLE ENCROACHMENTS OR PROJECTIONS OTHER THAN SHOWN.